

designed S.B.D.  
drawn T.J.C.  
checked S.B.D.  
date 02/03/12  
scale 1/4" = 1'-0" UNO.  
job no. 110244.ccm

Scott Blakeslee Disher  
AR-0011566 AA-0003285

GYPSUM ASSOCIATION DESIGN NO. FC 5406  
1 HR FIRE RATING

BASE LAYER 5/8" TYPE X GYPSUM WALLBOARD APPLIED AT RIGHT ANGLES TO 2x10 WOOD JOISTS 24" oc WITH 1 1/4" TYPE W OR S DRYWALL SCREWS 24" oc. FACE LAYER 5/8" TYPE X GYPSUM WALLBOARD OR VENEER BASE APPLIED AT RIGHT ANGLES TO JOISTS THROUGH BASE LAYER WITH 1 7/8" TYPE S DRYWALL SCREWS 12" oc AT JOINTS AND INTERMEDIATE JOISTS. FACE LAYER JOINTS OFFSET 24" FROM BASE LAYER JOINTS. 1 1/2" TYPE G DRYWALL SCREWS PLACED 2" BACK ON EITHER SIDE OF FACE LAYER END JOINTS. 12" oc 1/2" PLYWOOD WITH EXTERIOR GLUE APPLIED AT RIGHT ANGLES TO TOP OF JOISTS WITH 8d NAILS. CEILING PROVIDES ONE HOUR FIRE RESISTANCE PROTECTION FOR WOOD FRAMING, INCLUDING TRUSSES.

GYPSUM ASSOCIATION DESIGN NO. WP 1200  
1 HR FIRE RATING

ONE LAYER 5/8" TYPE X GYPSUM WALLBOARD OR VENEER BASE APPLIED AT RIGHT ANGLES OR PARALLEL TO EACH SIDE OF 3 5/8" (1 1/2") METAL STUD AT 24" oc WITH 1" TYPE S DRYWALL SCREWS AT 8" TO VERTICAL EDGES AND 12" oc TO TOP AND BOTTOM RIMMERS AND INTERMEDIATE STUDS. STAGGER ALL VERTICAL AND HORIZONTAL JOINTS 24" oc EACH SIDE AND OPPOSITE SIDES. ( NLR )

NON LOAD BEARING FRAMING OPTIONS  
 3 5/8" x 25ga STUDS AT 24" oc FOR HEIGHT TO 12'-3"  
 2 1/2" x 25ga STUDS AT 24" oc FOR HEIGHT TO 13'-0"  
 6" x 25ga STUDS AT 24" oc FOR HEIGHT TO 16'-3"  
 \* 3 5/8" x 20ga STUDS AT 24" oc FOR HEIGHT TO 17'-5"  
 4" x 20ga STUDS AT 16" oc FOR HEIGHT TO 16'-0"  
 6" x 20ga STUDS AT 16" oc FOR HEIGHT TO 24'-11"

2 RATED ASSEMBLY REFERENCE DATA  
1" = 1'-0"

**CONTRACTOR'S OPTION:**  
 AT CONTRACTOR'S OPTION WOOD STUD FRAMING MAY BE SUBSTITUTED WITH METAL STUD FRAMING AS FOLLOWS:  
 2x4 WOOD STUDS  
 3 5/8" x 25 GA. METAL STUDS  
 2x6 WOOD STUDS (NON-LOAD BEARING)  
 6" x 25 GA. METAL STUDS  
 2x8 WOOD STUDS (LOAD BEARING)  
 4" MIN. x 18 GA. METAL STUDS  
 CONTRACTOR SHALL MAKE FRACTIONAL ADJUSTMENTS IN FIELD

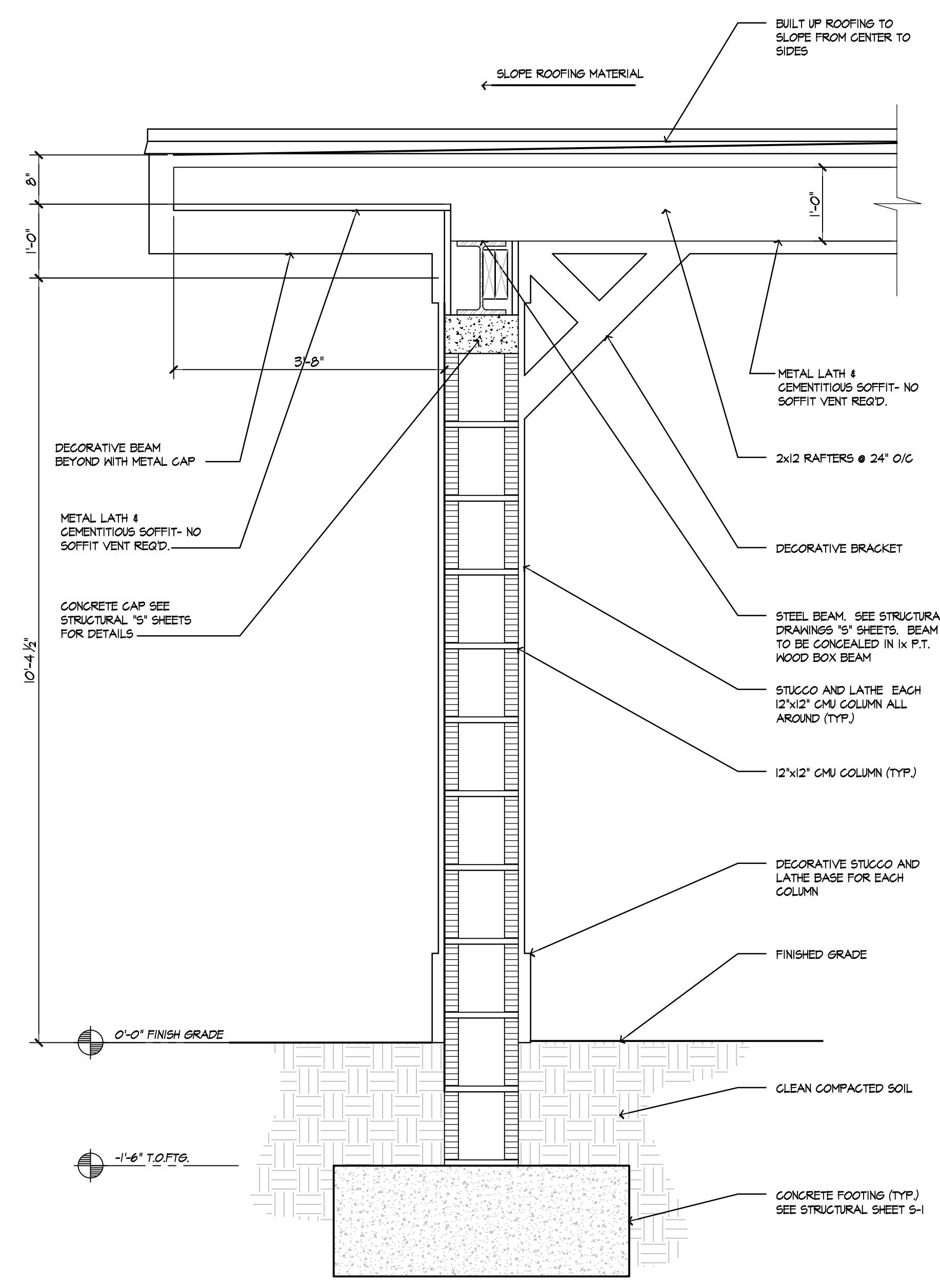

COVERED PLAY AREA SECTION/DETAIL  
SCALE 3/4" = 1'-0"

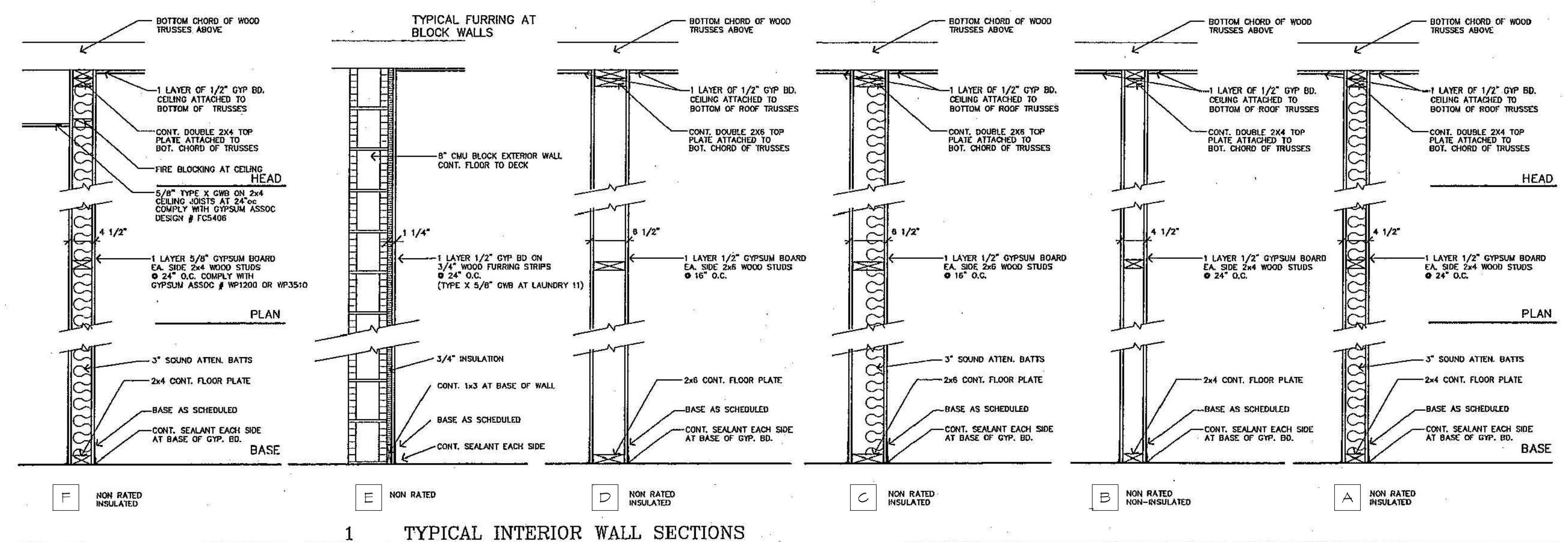

1 TYPICAL INTERIOR WALL SECTIONS  
1" = 1'-0"

- WALL SECTION NOTES:
- REFER TO FLOOR PLANS FOR LOCATION OF PARTITION TYPES AND TO SCHEDULES & DETAILS FOR WALL FINISHES.
  - ALL GYPSUM WALLBOARD SHALL BE 1/2" MINIMUM.
  - ALL GYPSUM WALLBOARD SHALL BE MOISTURE RESISTANT AT THE ROOM SIDE OF ALL WALLS FOR ALL TOILET ROOMS, PLUMBING WET WALLS AND WALLS ADJACENT TO PLUMBING WET WALLS, AND ALL WALLS WITH CERAMIC TILE FINISH, INCLUDING DRYWALL CEILING SCHEDULED FOR THESE AREAS.
  - SOUND ATTENUATION BLANKETS SHALL EXTEND FULL HEIGHT AND WIDTH OF PARTITIONS.
  - ALL RATED WALLS SHALL BE CONSTRUCTED FIRST. SECONDARY WALLS SHALL ABUT, NOT PENETRATE, RATED WALLS.
  - SUBMITTAL INFORMATION SHALL BE PROVIDED TO SUBSTANTIATE THAT THE MATERIALS AND ASSEMBLY USED BY THE CONTRACTOR HAVE BEEN TESTED BY A RECOGNIZED TESTING AGENCY TO MEET THE FIRE RESISTANCE RATING SCHEDULED ON THESE PARTITION TYPES.
  - FIRE STOPPING SHALL BE PROVIDED AT PENETRATIONS THROUGH RATED PARTITIONS.
  - REVIEW PLANS AND PROVIDE BRACING IN PARTITIONS AS REQUIRED FOR CASEWORK, EQUIPMENT, ETC. IF WOOD BLOCKING IS REQUIRED PROVIDE FIRE RETARDANT TREATED WOOD BLOCKING.
  - SPACING OF STUDS SHALL NOT EXCEED 24" ON CENTER UNLESS SPECIFICALLY NOTED OTHERWISE.

CLUBHOUSE UNIVERSITY DAYCARE  
JUPITER FARMS SHOPPING CENTER  
PALM BEACH COUNTY, FLORIDA  
project

ARCHITECTURAL  
Studio, Inc.

Architecture  
Planning

300 Avenue of Champions  
Suite 260  
Palm Beach Gardens, Florida 33418  
Phone 561.202.6990  
Fax 561.296.2494  
archstudiofl.com

drawing  
INTERIOR  
WALL  
SECTIONS

sheet  
A-8

of